

# Hyams Umbrella Hyams LED Umbrella

# K I N G

## Assembly | User Guide

Two people are required for safe assembly

### Opening Boxes:

DO NOT use a knife to open the packaging as you may damage your furniture.

Peel off the tape, then lift & separate the cardboard flaps to open.

Assemble your furniture by following the instructions below.

1

### Components

Hyams Umbrella  
Hyams LED Umbrella

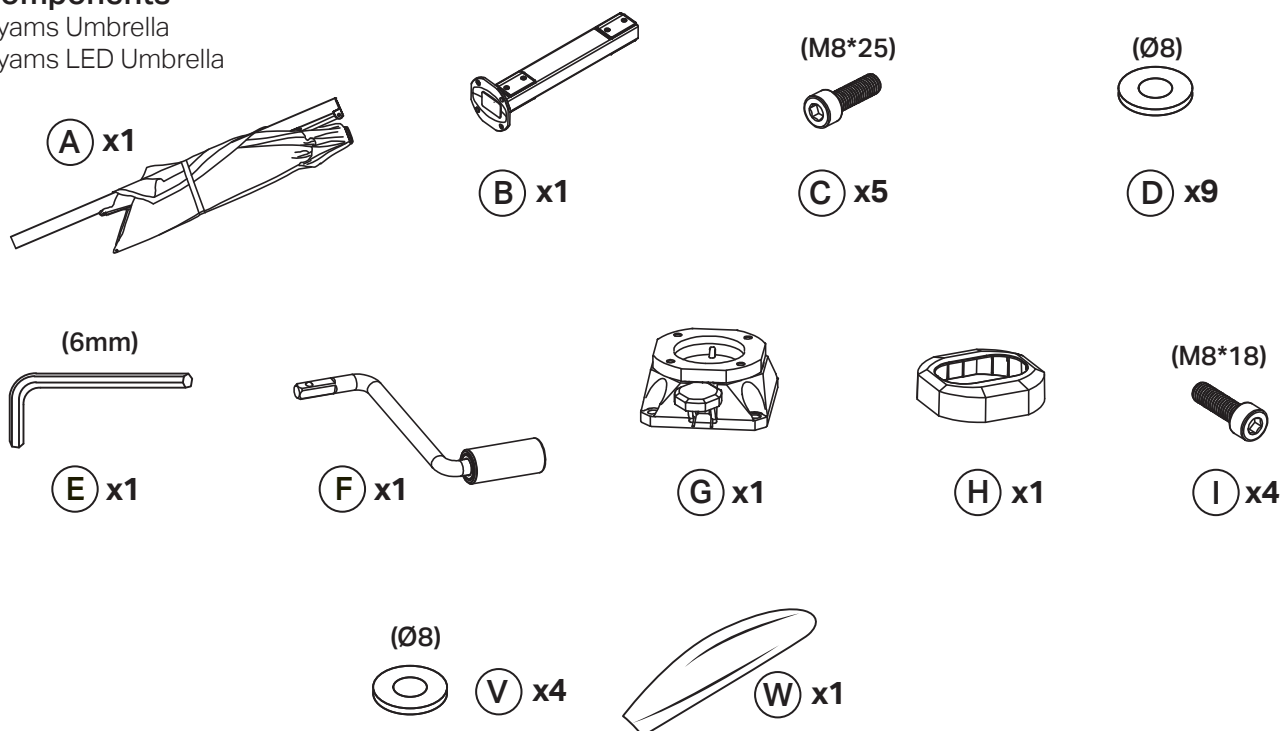

### Components

Base: Hyams Umbrella  
Base: Hyams LED Umbrella

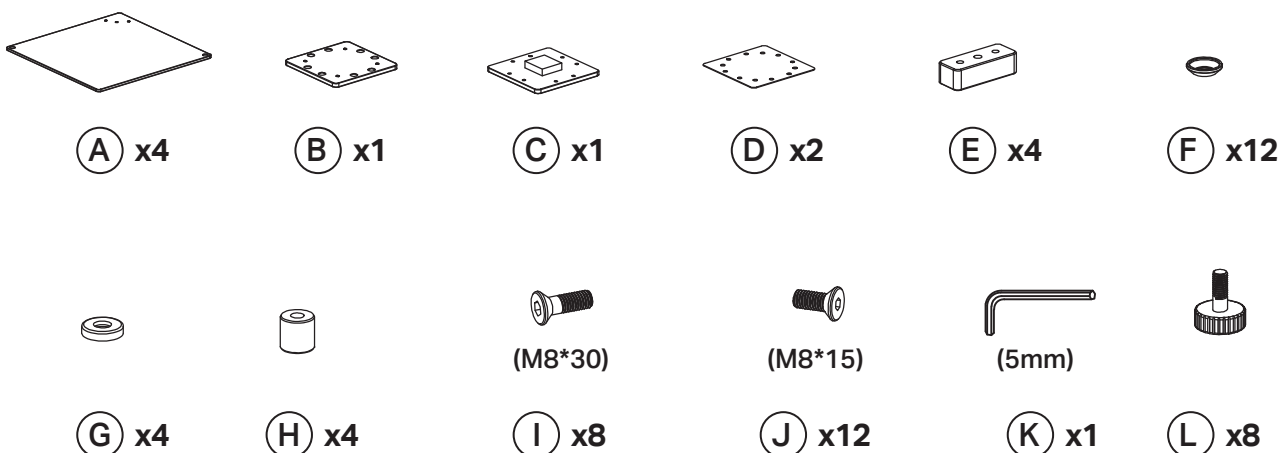

Base: Hyams Umbrella  
Base: Hyams LED Umbrella

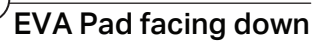

Base: Hyams Umbrella  
Base: Hyams LED Umbrella



2

**Assembly**

Hyams Umbrella  
Hyams LED Umbrella

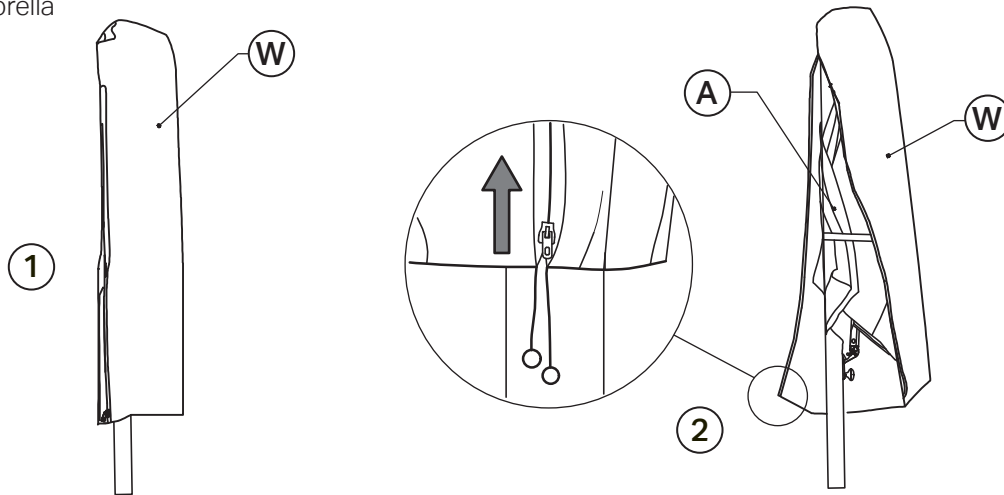

3

**Assembly**

Hyams Umbrella

**Assembly**

Hyams LED Umbrella

>Go to: **Steps 11-16**

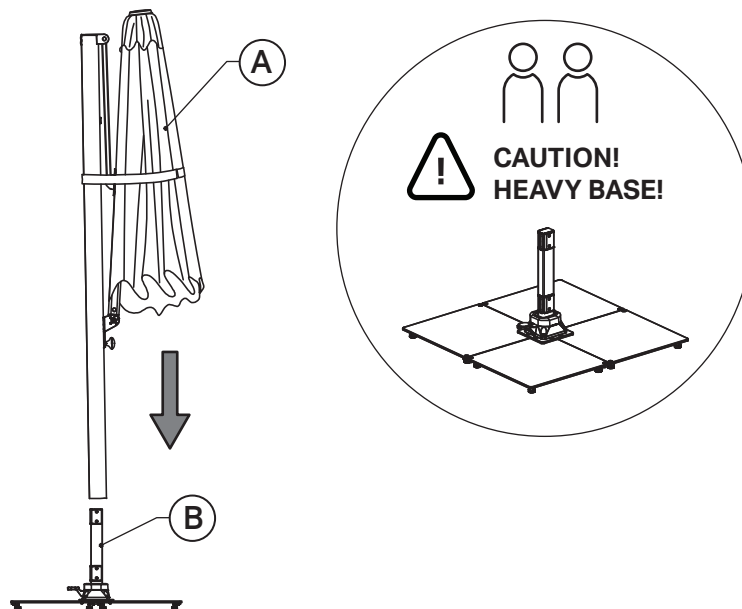

4

**Assembly**

Hyams Umbrella

Hyams LED Umbrella

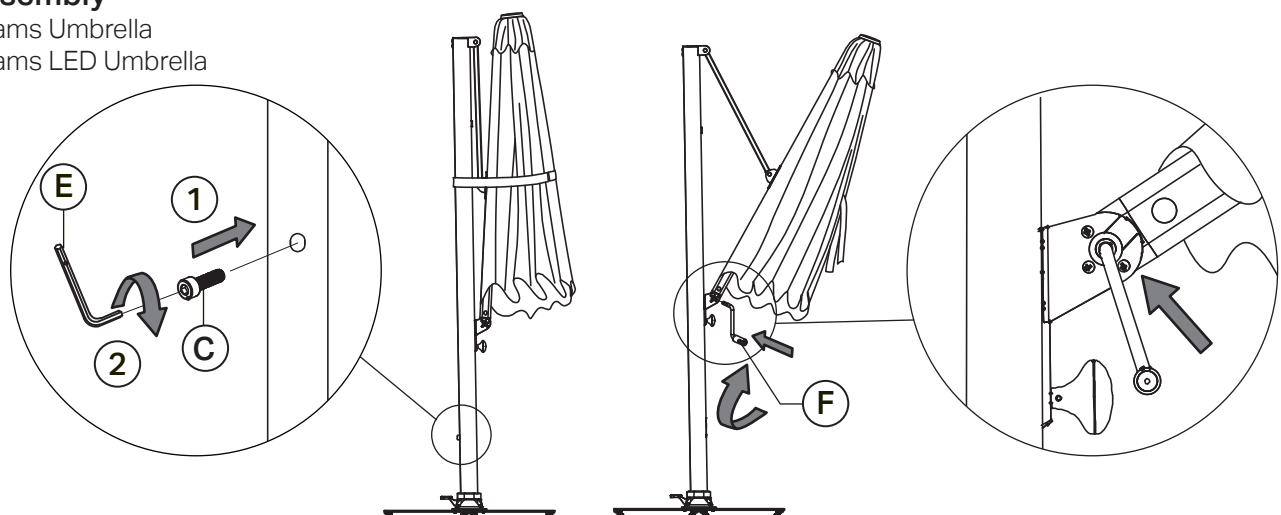

5

**User Guide**

Hyams Umbrella  
Hyams LED Umbrella

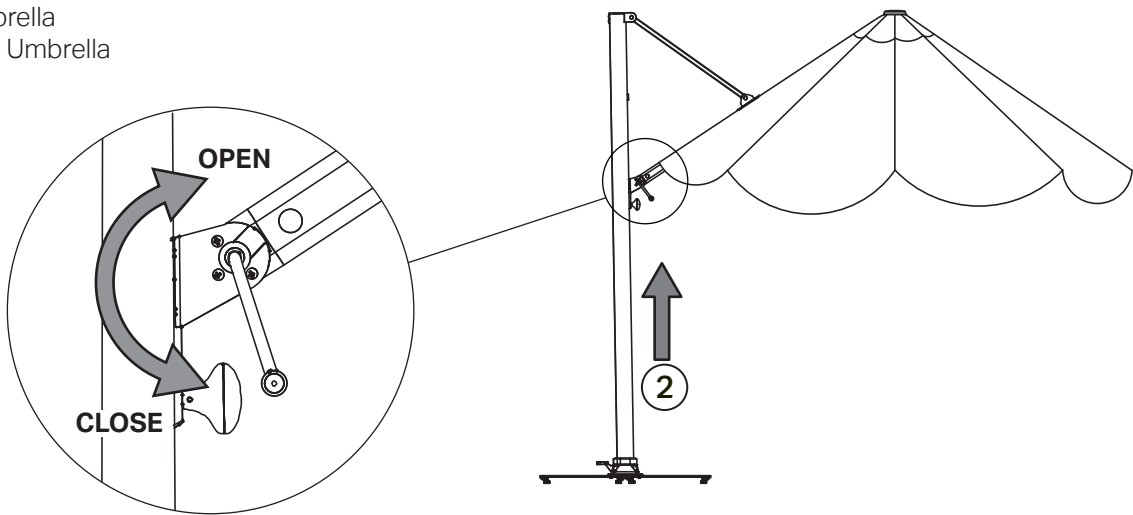

6

**User Guide**

Hyams Umbrella  
Hyams LED Umbrella

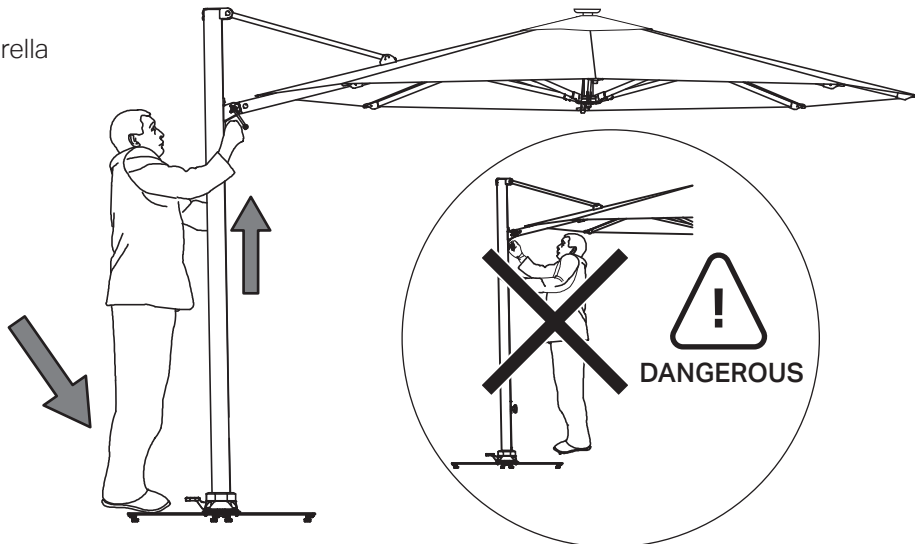

7

**User Guide**

Hyams Umbrella  
Hyams LED Umbrella

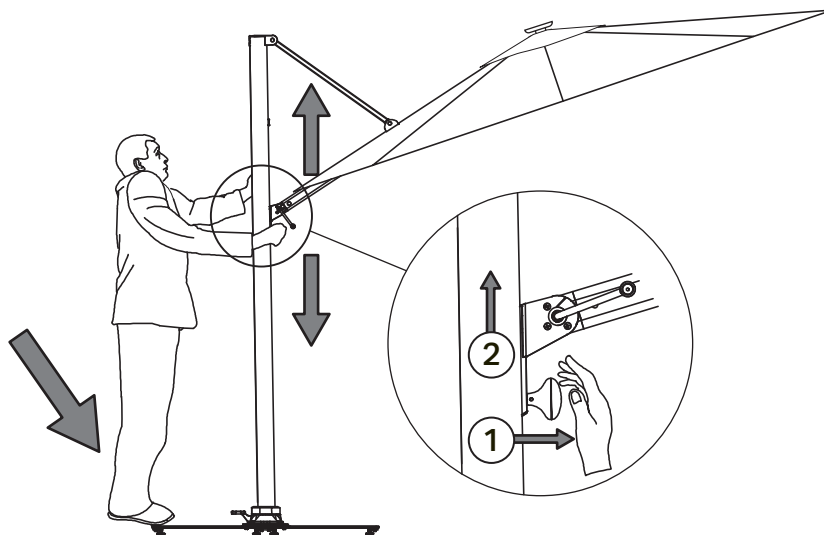

8

**User Guide**

Hyams Umbrella  
Hyams LED Umbrella

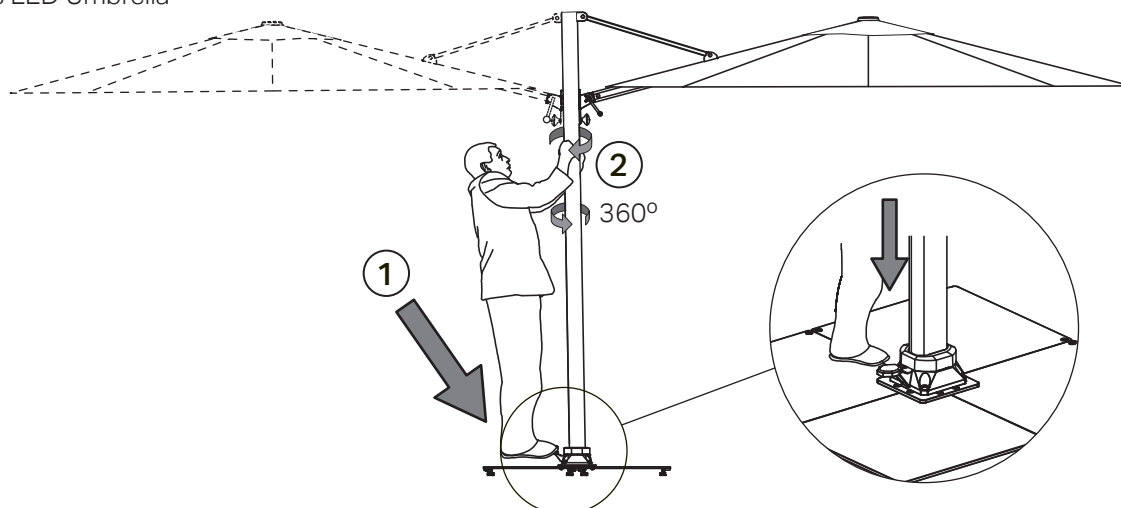

9

**User Guide**

Hyams Umbrella  
Hyams LED Umbrella

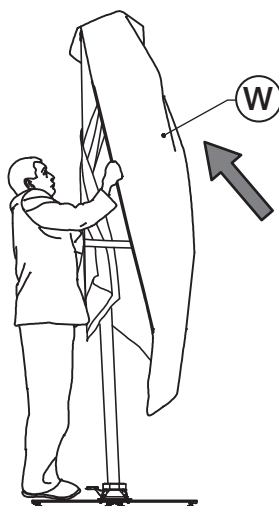

10

**User Guide**

Hyams Umbrella  
Hyams LED Umbrella



**WARNING!**  
KEEP UMBRELLA  
CLOSED IN WINDY  
CONDITIONS AND  
WHEN NOT IN USE.

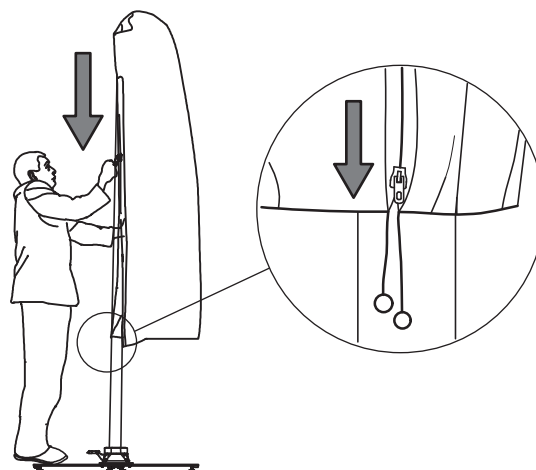

11

**LED Assembly**Hyams LED Umbrella  
LED Components and Assembly

AA x1

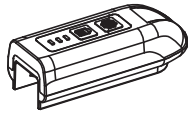

BB x1

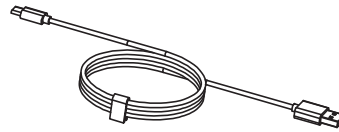

CC x1



DD x1

12

**LED Assembly**

Hyams LED Umbrella

1

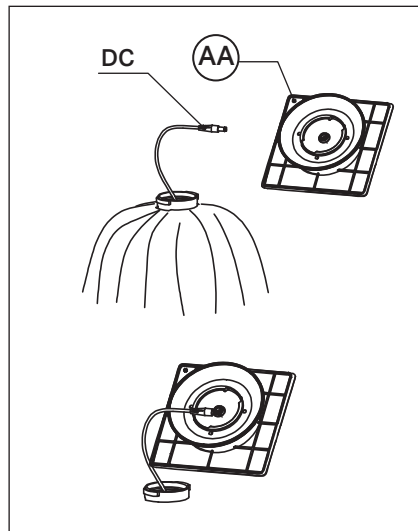

2

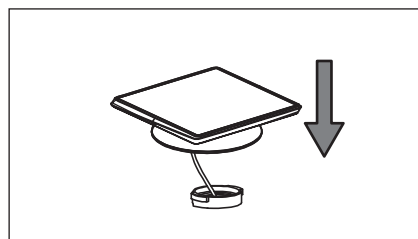

3

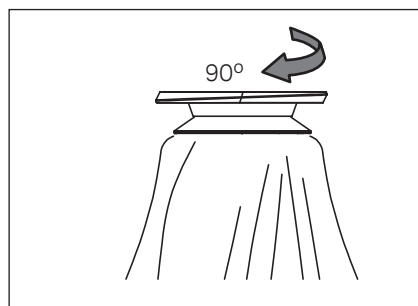

4

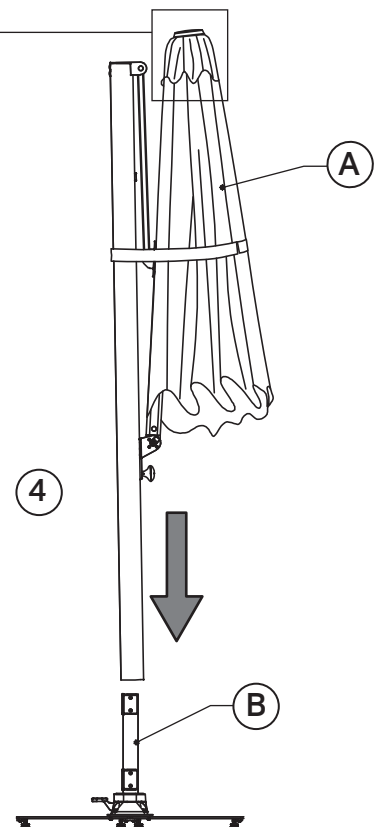

13

**LED Assembly**

Hyams LED Umbrella

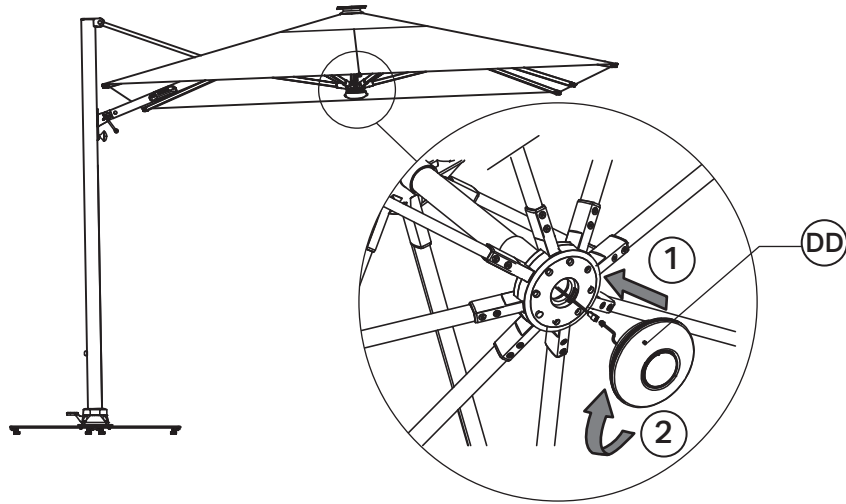

14

**LED Assembly**

Hyams LED Umbrella

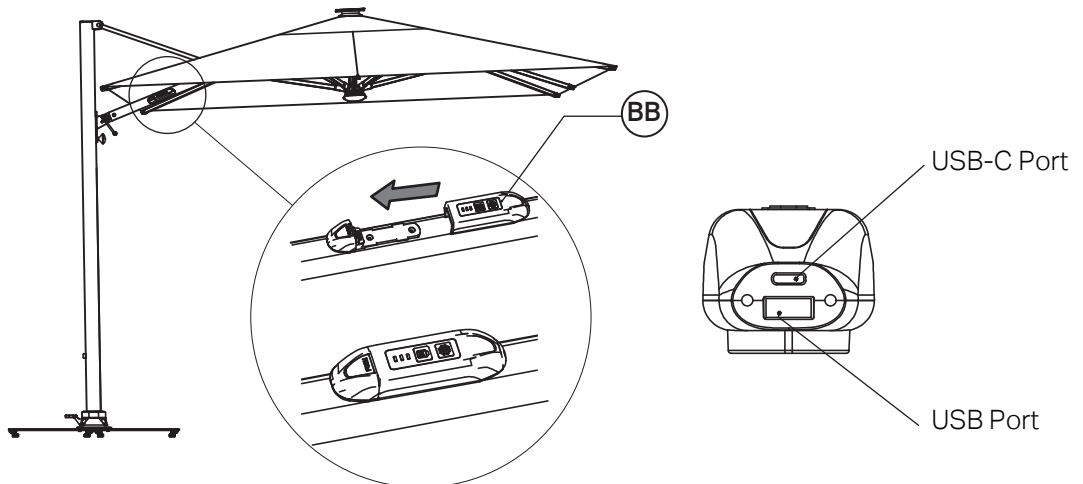

15

**LED User Guide**

Hyams LED Umbrella

Control Unit:

- Go to: **Step 16**

**Assembly**

Hyams LED Umbrella

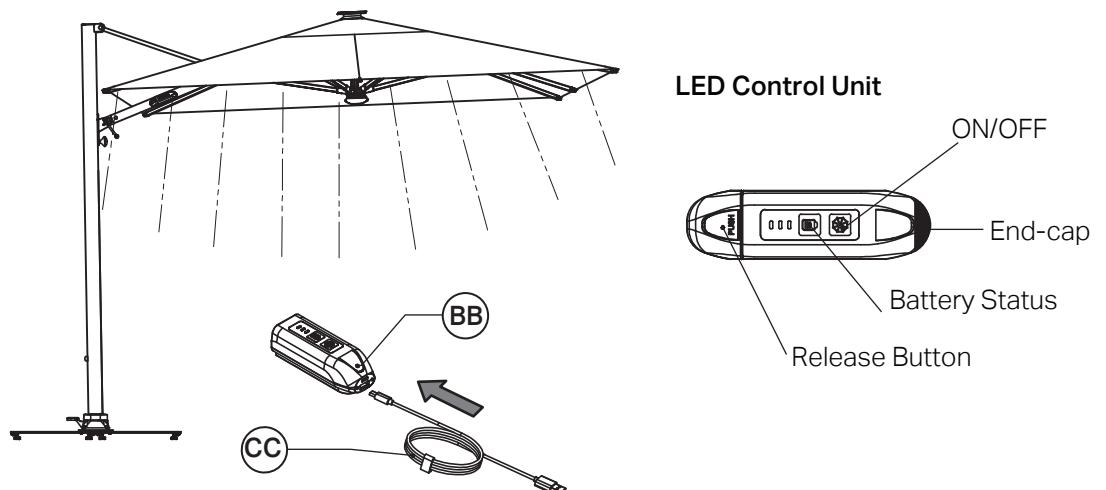
<Go to: **Steps 4-10**

## Hyams LED Umbrella: Control Unit



Do NOT OPEN or DISMANTLE multi-functional Control Unit:

Functions: • LED Operation • Battery / Energy Station • LED Circuit Connector

### Operate LED Light:

- 1: Charge battery via Solar or USB-C Port
  - **Solar charge**: full charge 10 hours
  - **USB-C Port** (DC 5V / 1A): full charge 6 hours (see below)
- 2: Connect Control Unit to Umbrella Frame to complete LED circuit
- 3: Press  **ON/OFF** to operate LED Light

### To charge battery via USB-C Port

- ① **PUSH** to release **Control Unit** from **Umbrella Frame**

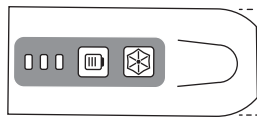
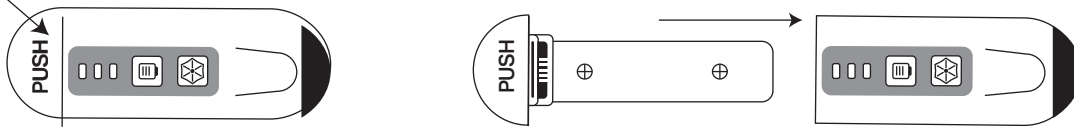

- ② To charge battery; remove **End-cap**

Charge Status  
**Red**: Charging  
**Green**: Charged

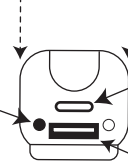

- ③ Connect charge cable to **USB-C Port**

**USB Port**

Battery Status

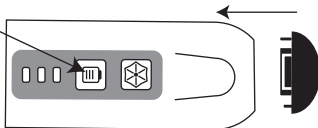

- ④ When battery charged; replace **End-cap**

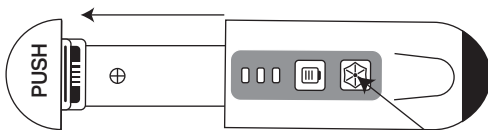

- ⑤ Reconnect **Control Unit** to **Umbrella Frame**



Control Unit must be connected to Umbrella Frame to complete LED circuit

- ⑥ **ON/OFF**

Specifications:

Battery capacity: 5200mAh

- Supports LED lighting up to 5~6 Hours

Solar charge speed ≈ LED consumption speed:

- Battery charges in advance
- LED Light ≈ 80% capacity after 5000 hours